

## Technical Bulletin

Subject: Service Champ CF5515 / WLP2017 / CH-9549 Design Change

TB 01-07

Date: March, 2007

The CF5515 oil filter is changing to a new design that requires the use of a core adapter. The addition of the core adapter allows the use of high performance filters that are less expensive than the Original Equipment filter design. This new filter meets all of the demanding filtration requirements for the Ford Powerstroke engine.

The core adapter is designed to last the life of the engine so there is no need to replace it at each oil change. Each CF5515 will include a core adapter but if one has already been installed you can simply dispose of the extra adapter. On most vehicles, the core adapter must be installed as indicated in the included instruction sheet or the filter cap will not thread onto the filter housing. Installation of the core adapter will still allow the use of OEM and all other filter brands.

Below are the basics regarding the installation of the core adapter. Each filter will come with complete installation instructions in both English and Spanish. For more information visit [www.coreadapter.com](http://www.coreadapter.com).

Align the slots of the core adapter with the holes on the top of the core assembly.  
(See Fig. 1)

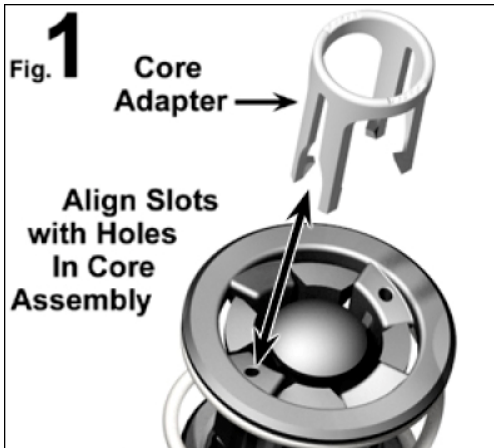

Carefully push adapter into the core assembly. Mild resistance may be felt during installation. (See Fig. 2)



With core adapter in position, (See Fig. 3)





Press core adapter firmly to snap in place. ( See Fig. 4)



- **Installation Note:** Some filter brands use a two-piece design with an extra disc that snaps into the filter cap. If present, this extra disc must first be removed before the CF5515 or an OEM filter can be snapped into the filter cap.

**For More Information Call Our Filter Hotline (800) 882-0890**

**Service Instructions: IMPORTANT! - First Determine Housing Style Before Servicing**

1. A "Core Adapter"  is required to service Style A housings. (See illustrations at right.) To service Style A housings proceed to Step 2. To service Style B housings discard the core adapter and proceed to Step 6.
2. If a core adapter has already been installed, proceed to step 6, filter installation. With the core adapter installed, you may still use the OEM and all other brands of filters.
3. Align the slots of the core adapter with the holes on the top of the core assembly. (See Fig. 1) 
4. Carefully push adapter into the core assembly. Mild resistance may be felt during installation. (See Fig. 2)
5. With core adapter in position, (See Fig. 3), press core adapter firmly to snap in place. (See Fig. 4)
6. Remove the old O-ring, lubricate new O-ring with clean oil and install on cap.
7. Install filter element and threaded cap.
8. Tighten cap to 18.5 ft-lbs.

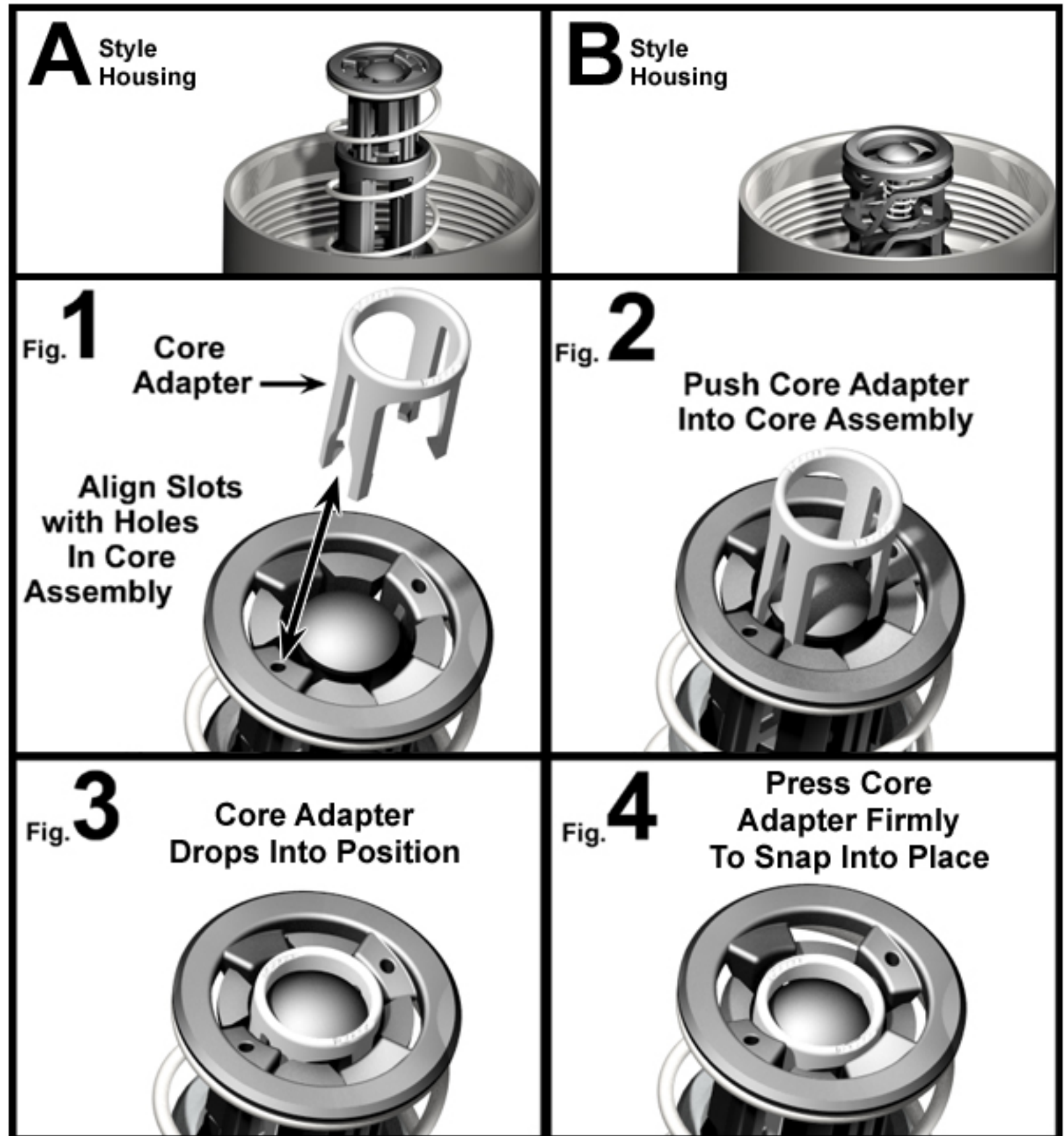

Need Help? See [www.coreadapter.com](http://www.coreadapter.com) for more details and installation video.

- IMPORTANTE, Lea Primero - IMPORTANT, Read First -

- IMPORTANTE, Lea Primero - IMPORTANT, Read First -